

EyeGility™ Inserter

Loading Guide

enVista™ & enVista™ Toric preloaded IOLs
with the EyeGility™ Delivery System

Use sterile garments and work in a sterile field when preparing Bausch + Lomb delivery systems and delivering IOLs.

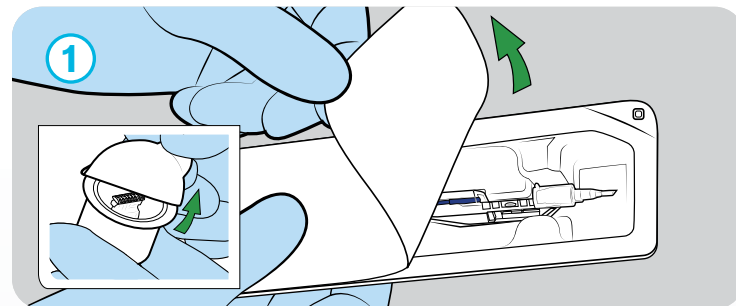

- Open the carton and remove the inserter tray and IOL pouch.
- Peel back the Tyvek® lid to remove the inserter from the tray and place in the sterile field.
- Peel open the IOL pouch to remove the IOL vial and place in the sterile field.
- Open the IOL vial by peeling away the lid.

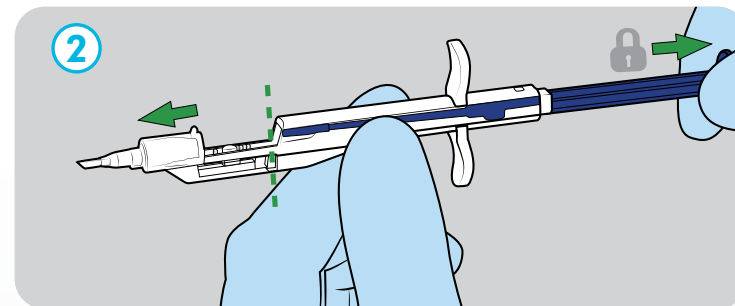

- Ensure that the inserter plunger is fully retracted by grasping the inserter mid-body and using your second hand to pull the plunger end away from the inserter tip until you feel it snap into its lock position.
- Ensure the cartridge is pushed forward and pressed against the end of the inserter body delivery channel.
- The inserter is now ready to receive the IOL shuttle.

*The plunger may already be in the correct position.
The cartridge may already be in the correct position.*

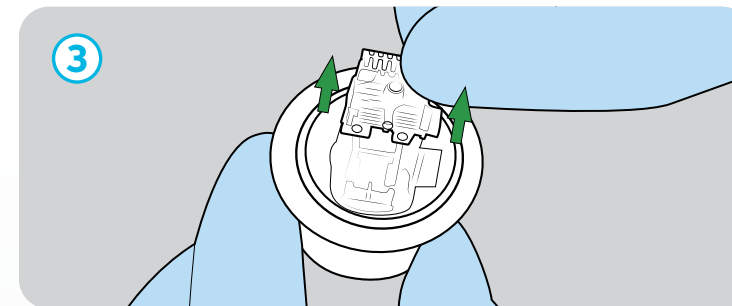

- Position thumb and finger on sides of shuttle and lift up.
- Do not shake the IOL shuttle after removing from the IOL vial.

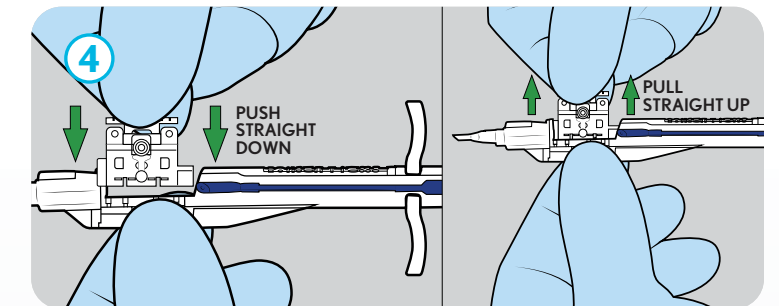

- Using your other hand's thumb and index finger, hold the sides of the inserter body directly underneath the loading area.
- Ensuring the IOL shuttle's tail is facing toward the plunger end of the inserter body, insert the shuttle **straight down** into the loading area (*you may hear an audible "click"*).
- Visually confirm that the IOL shuttle is sitting flush with the inserter body (the top of the shuttle should be horizontal).
- Physically confirm that the IOL shuttle legs are locked into position by vertically pulling **straight up**.

Readjust shuttle if initial attempt is unsuccessful.

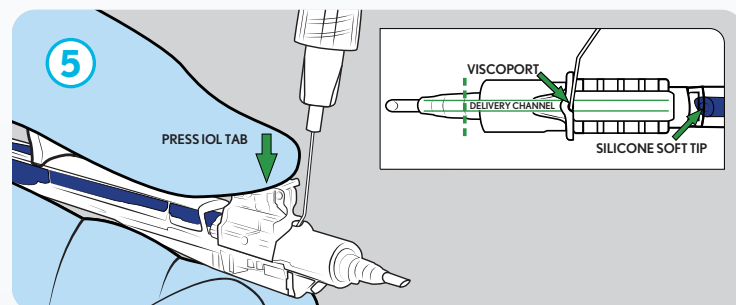

- Press the IOL tab with your thumb while applying Bausch + Lomb recommended viscoelastic* into the viscoport.
- Visually verify that the viscoelastic has filled the delivery channel up to the mark designated in the image above.
- Release the IOL tab.
- **Add a drop of viscoelastic to the silicone soft tip of the plunger.**

*Amvisc™, Amvisc™ Plus and OcuCoat™

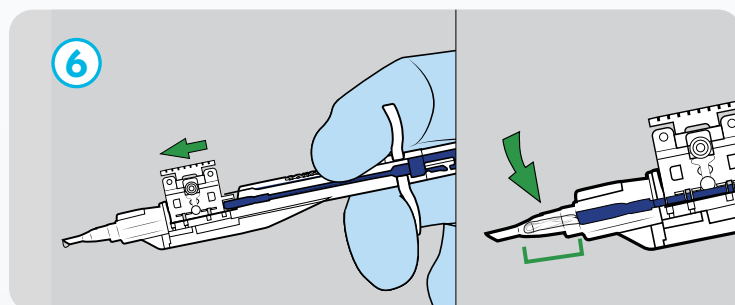

- While holding the assembled inserter with one hand, thumb on the end of the plunger and middle and index finger on the supporting wings, gently advance the plunger towards the IOL shuttle.
- Visually confirm that the silicone soft tip enters the IOL shuttle without deforming.
- With the same hand position, continue to advance the plunger's silicone soft tip until the lens is in the cartridge tip.
- Pull the plunger back slightly to visually confirm that the lens stays in the cartridge then return the silicone soft tip to its previous position.
- The lens is now ready to be delivered.

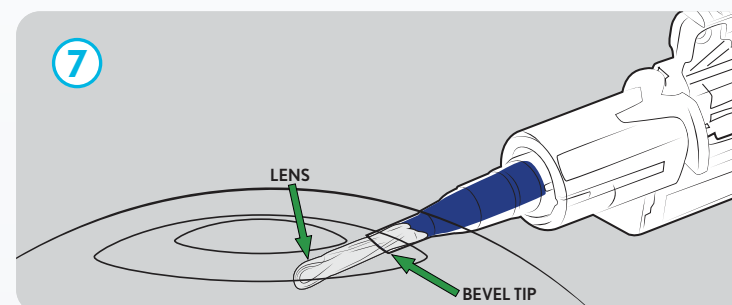

- To deliver the lens, place the inserter's cartridge tip into the surgically induced incision with the bevel tip facing down.
- Slowly advance the plunger using your thumb until the lens is fully released into the eye, observing the delivery is smooth and controlled.
- It is recommended to take at least 5 seconds (approximately) to advance the lens into the eye.

If the soft tip ejects beyond the cartridge tip it can be retracted into the cartridge tip by pulling back the plunger with your second hand before removing the tip from the incision.

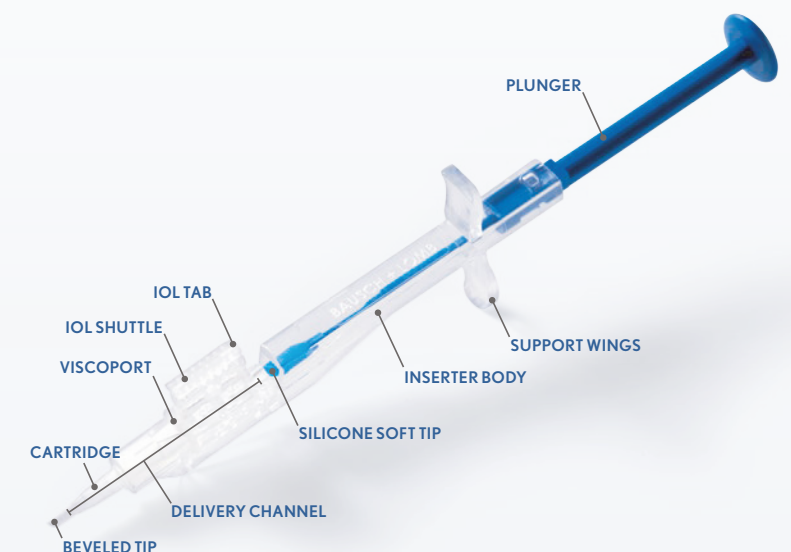

IF DONE
CORRECTLY

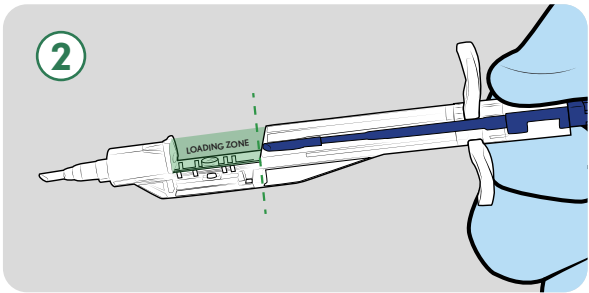

- The inserter plunger is fully retracted.

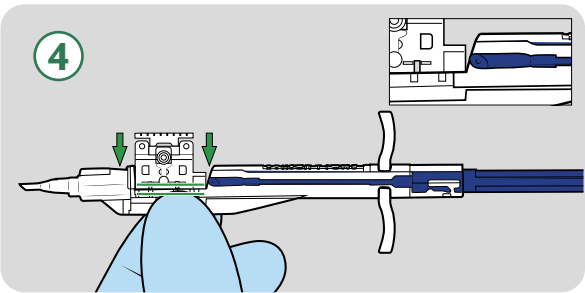

- The IOL shuttle's tail is facing toward the plunger end of the inserter body, inserted **straight down** into the loading area.
- Visual and physical inspections done correctly.

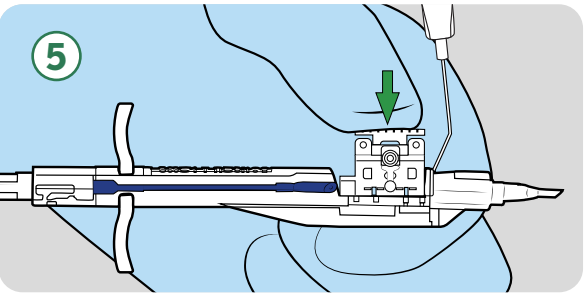

- Hold down the IOL shuttle tab with your thumb while applying the correct amount of a Bausch + Lomb recommended viscoelastic into the viscoport.

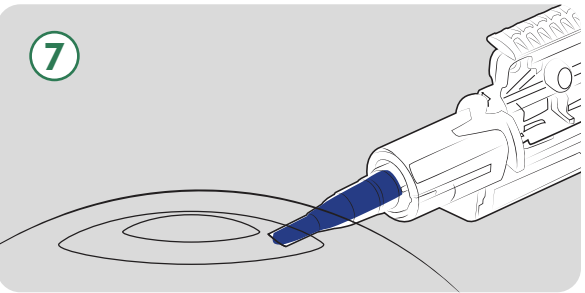

- In the situation where the silicone soft tip extends beyond the cartridge tip opening, the soft tip is retracted into the cartridge tip by pulling back the plunger with your second hand before removing the tip from the incision.

IF DONE
INCORRECTLY

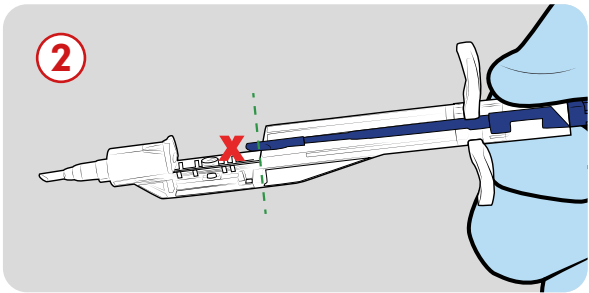

- The inserter plunger silicone soft tip is left suspended above the loading area.
**This may cause damage to the plunger during IOL shuttle loading, potentially causing damage to the IOL during IOL advancement.*

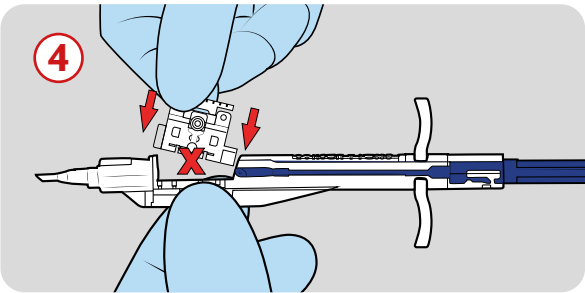

- The IOL shuttle is **NOT** inserted **straight down** into the loading area.
- The IOL shuttle is **NOT** sitting flush with the inserter body.
**This may cause the plunger silicone soft tip to either override or underide the lens, causing lens damage during IOL delivery.*
- The top of the IOL shuttle is **NOT** horizontal.
** This may cause the IOL shuttle to become detached during the advancement of the plunger or this may cause the plunger silicone soft tip to either override or underide the lens, causing lens damage during IOL delivery.*

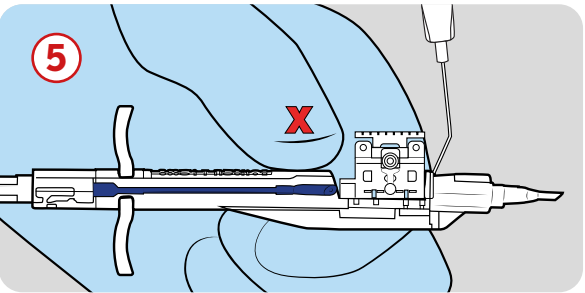

- Applying a Bausch + Lomb recommended viscoelastic into the viscoport while **NOT** holding down the IOL shuttle tab with your thumb.
** This may cause the IOL to not orientate correctly during lens delivery, potentially causing haptic issues, including haptic entrapment.*
** This may affect viscoelastic to not fully penetrate the IOL shuttle chamber, causing a notable increase in push-force for you during IOL advancement and delivery.*

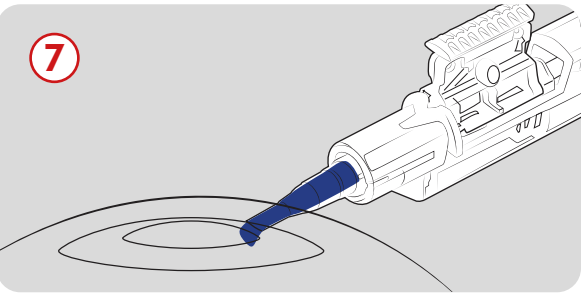

- In the situation where the silicone soft tip extends beyond the cartridge tip opening, the soft tip is **NOT** retracted into the cartridge tip by pulling back the plunger with your second hand before removing the tip from the incision.
**This may cause damage to your surgically induced incision.*
- Forgo IOL delivery in an instance of haptic entrapment. Repeat process with a new inserter and backup IOL.

EyeGility™ Inserter

RECOMMENDED INCISION SIZE 2.0 mm
TYPE OF ACTION Push-type
COMMENTS Semi-preload. Single use. Disposable

